

BREAKOUT SESSIONS

SESSION 1: MONDAY, 3:30 - 4:30 P.M.

- E** Best Practices for Executive Pastors and Second Chair Leaders
Caleb Duvick • Cedar C
- Q** Does What You Teach on Sunday Impact Families Throughout the Week?
Kendra Joyner • Maple
- F** Faithful and Wise Stewardship for Every Stage of Life
Erich Hamm and Scott Setzer • Cedar B
- H** How the Gospel Multiplies
Clayton Greene, JD Greear, Andrew Hopper, Spence Shelton • Auditorium 4
- J** Leading Well: Becoming a Healthy Pastor in a World of Unhealthy Leadership
Sandy Marks • Colony B
- K** Marketing Your Church Well: One Size Does Not Fit All
Kathryn Carson and Daniel Spivey • Colony C
- I** Meal Planning: How Pastors Prepare to Feast on God's Word
Ronjour Locke • Colony A
- N** On Mission Together Across our State and Around the World
Baptist on Mission • Turnberry
- B** Reaching the Peoples Next Door Again
Zac Lyons • Oak C
- G** Real Life Faith Conversations for Women: Sharing Authentically in a Complex World
Meredith Snoddy • Cedar A
- C** Starting a Lay Counseling Ministry
Brad Hambrick • Oak B
- O** Students and Mental Health
Merrie Johnson • Pinehurst
- M** Transitional Interim Ministry
Allan Blume • Heritage B

- A** Unstuck: Starting My Church's Pathway Forward
Terry Long • Auditorium 1
- L** What Is New in WMU?
Amy Boone • Heritage A
- D** When the Church Understands Trauma: Seeing the Hurt and Sharing Hope
Tera Melber • Oak A

SESSION 2: TUESDAY, 11 A.M. - NOON

- G** Am I Called to Plant a Church?
Mike Pittman • Cedar A
- E** Building a Thriving and Cost-Effective Stewardship Ministry With Christian Money Solutions
Art Rainer • Cedar C
- Q** Does What You Teach on Sunday Impact Families Throughout the Week?
Kendra Joyner • Maple
- O** Foundations of Student Ministry
Daniel Rose • Pinehurst
- H** Fruitland Listening Session
Fruitland Advisory Team • Auditorium 4
- J** Leading Well: Becoming a Healthy Pastor in a World of Unhealthy Leadership
Sandy Marks • Colony B
- K** Marketing Your Church Well: One Size Does Not Fit All
Kathryn Carson and Daniel Spivey • Colony C
- I** Meal Planning: How Pastors Prepare to Feast on God's Word
Ronjour Locke • Colony A
- C** Missions Engagement
Janet Packard • Oak B

SESSION 2 (CONT.): TUESDAY, 11 A.M. - NOON

- N** On Mission Together Across our State and Around the World
Baptist on Mission • Turnberry
- D** On Mission Together: Empowering the Church to Bring Gospel Hope to the Hurting
Erica Spivey, Tara Sessoms, Rick Norman • Oak A
- B** Reaching the Peoples Next Door Again
Zac Lyons • Oak C
- M** Transitional Interim Ministry
Allan Blume • Heritage B
- A** Unstuck: Starting My Church's Pathway Forward
Terry Long • Auditorium 1
- L** What They Didn't Teach You in Seminary: Church Finances and Taxes
Davis Blount • Heritage A
- F** Wise Borrowing for Kingdom Building: A Practical Guide to Church Loans
Daryl Trexler and James Zik • Cedar B

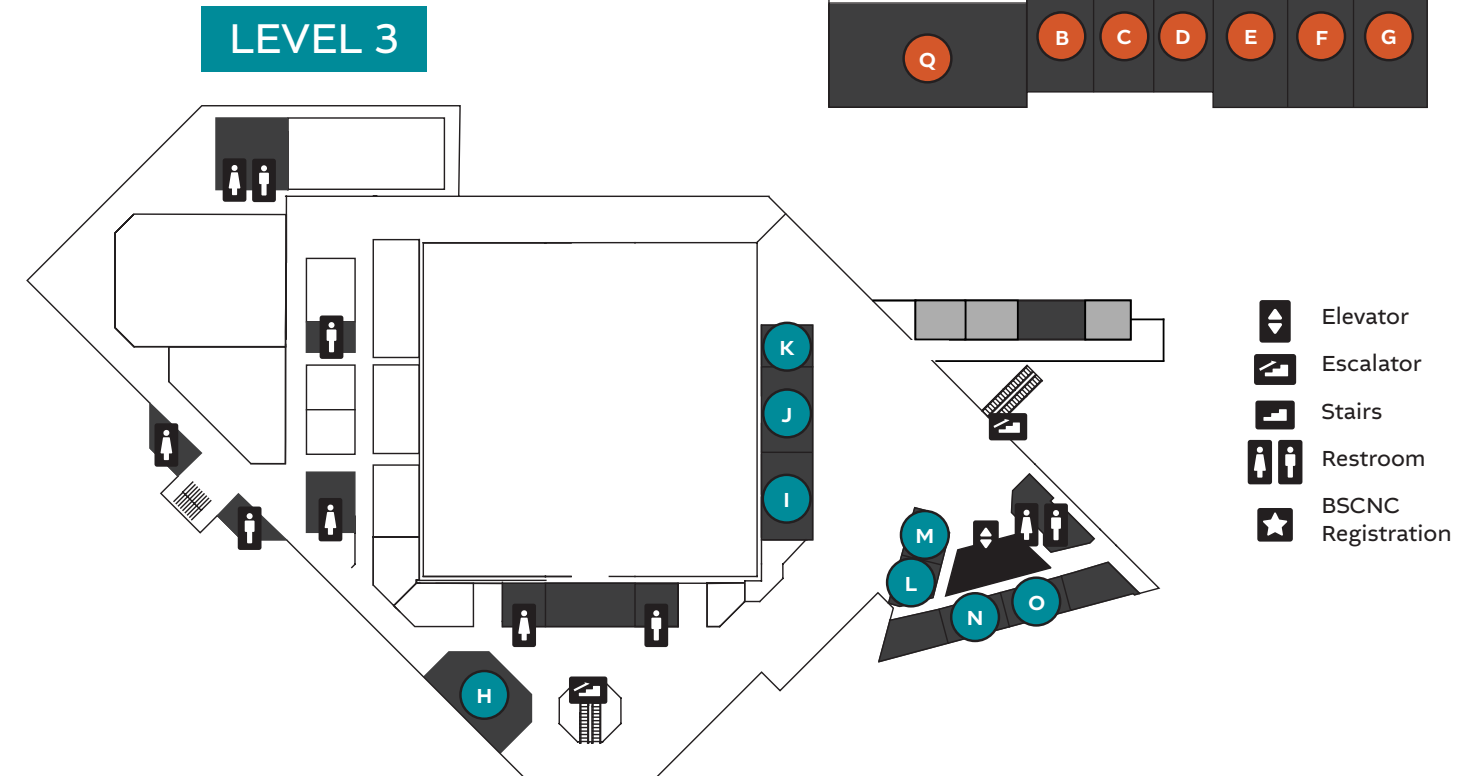
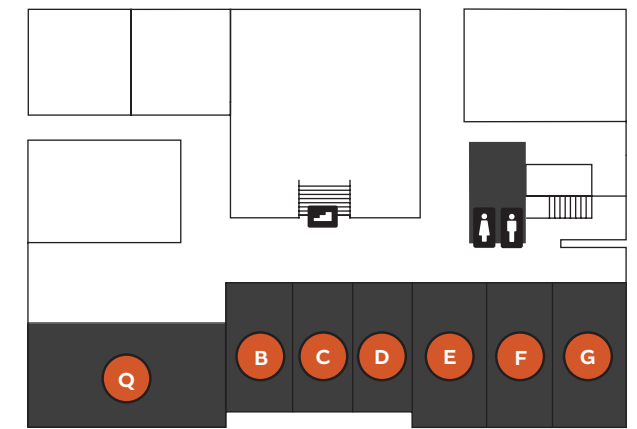
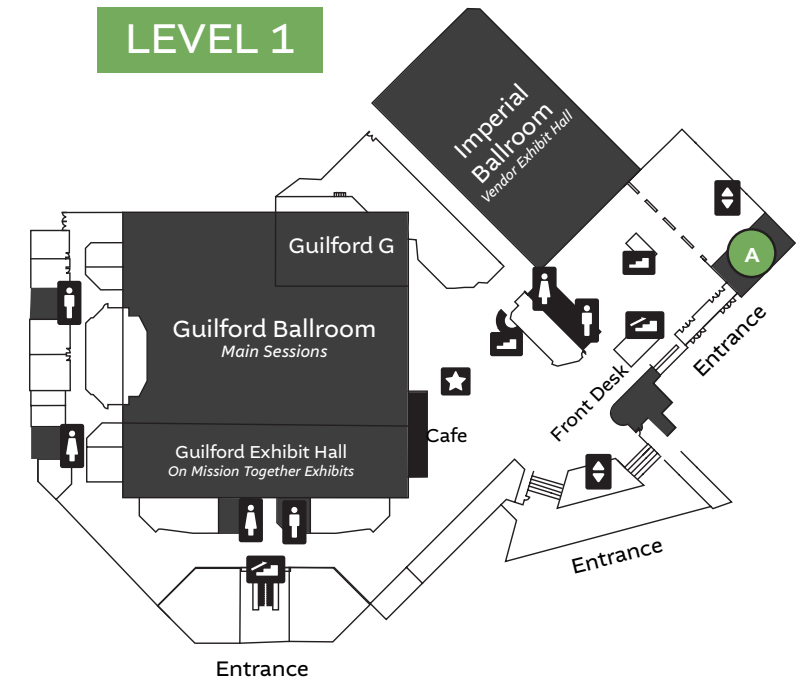

Level 2 breakout sessions are accessed by the spiral staircase in hotel lobby. Letters in circles correspond to maps on the page to the right.